



TENTATIVE SCHEDULE

***Registration and sessions held at the Promised Land Chapel at Laguna.**

FRIDAY, JUNE 21

2:00-4:00 Registration

Alpha

5:00-5:45 Dinner
6:00-7:30 Session 1
8:00 Church Time (optional)
11:30 Back in Rooms

Omega

6:15-7:00 Dinner
8:00-9:30 Session 1
10:00 Church Time (optional)
11:30 Back in Rooms

5:00-5:45

Dinner

6:00-7:30

Session 5

8:00

Church Time (optional)

11:30

Back in Rooms

Omega

8:15-9:30 Breakfast
11:00-12:30 Session 4
12:30-1:30 Lunch
2:00-4:00 Recreation
6:15-7:00 Dinner
8:00-9:30 Session 5
10:00 Church Time (optional)
11:30 Back in Rooms

SATURDAY, JUNE 22

Alpha

7:00-7:45 Breakfast
8:30-10:00 Session 2
11:30-12:30 Lunch
2:00-4:00 Recreation
5:00-5:45 Dinner
6:00-7:30 Session 3
8:00 Church Time (optional)
11:30 Back in Rooms

Omega

8:15-9:30 Breakfast
11:00-12:30 Session 2
12:30-1:30 Lunch
2:00-4:00 Recreation
6:15-7:00 Dinner
8:00-9:30 Session 3
10:00 Church Time (optional)
11:30 Back in Rooms

MONDAY, JUNE 24

7:30

Breakfast

9:30

Check Out

SUNDAY, JUNE 23

Alpha

7:00-7:45 Breakfast
8:30-10:00 Session 4
11:30-12:30 Lunch
2:00-4:00 Recreation



WHAT TO BRING:

- Bible, notebook and pen
- Sheets, pillow, sleeping bag or blanket
- Toiletries (soap, shampoo, deodorant, toothpaste, etc.)
- Towels, washcloths, beach towels
- Enough modest casual clothes for the entire camp (4 days/3 nights)
- Modest bathing suit (at student pastor's discretion)
- Sunscreen, aloe vera
- Bug spray
- Items for the beach (frisbee, volleyball, etc.)
- Closed toe shoes for rec time
- Coolers and water for rec time
- Flashlights (if you want to have Church Time on the beach)
- Spending money for snacks or STS/artist merchandise
- First aid kit for your group

WHAT NOT TO BRING:

- "Short" shorts or skirts
- Tight clothing
- Halter, tube or spaghetti strap tops
- TVs or gaming systems
- Tobacco, alcohol or illegal drugs
- Fireworks of any nature
- Weapons of any kind (guns, knives, etc.)
- Any paraphernalia for pranks
- Clothing with questionable or inappropriate slogans, images, etc.
- Clothing that promotes alcohol, tobacco, or inappropriate items
- Anything else that would be a distraction for your group or other churches



GENERAL WAIVER AND RELEASE

- ALL participants in STS Camp must sign a Waiver and Release form. This includes **participating campers and adults 18 years and older**.
- Participants under 18 must have the authorized signature of a Parent/Guardian.
- Please return this form to your group leader – they are responsible for submission.

Strength to Stand Camp (STS Camp) is a ministry of Scott Dawson Evangelistic Association (SDEA). SDEA wants you or your child's experience at STS Camp to be a safe and healthy one. SDEA will work with your church to provide a safe environment for you and/or your child. However, in the event of an accident, it is important that we have the following information.

Church Name: _____

Name of Child or Attendee: _____ Birthdate: ____/____/____ Age: _____

Camp Date: _____

Release/Indemnification. I hereby consent to the above listed participation and release absolutely, hold harmless and covenant not to sue Scott Dawson Evangelistic Association, its directors, employees, volunteers, and affiliates from any and all present or future liability, claims, demands, actions or rights of action, whether asserted by me or a third party arising out of my (or my child's) participation in event activities (the "Claims"). I agree to indemnify and hold harmless SDEA, STS Camp for any such Claims brought by me or a third party from any costs associated with defending or litigating such claims, including but not limited to attorney fees, costs and legal expenses.

Medical Emergency. In the event of injury or a medical emergency, I understand that the church's group leader, not SDEA or STS Camp, will be responsible for the medical care of all attendees. SDEA, STS Camp staff will certainly provide assistance but it will be the church group leader's responsibility to assess medical needs, obtain and consent to appropriate medical care, transport persons in need of medical care and contact parents or guardians of minors. I release SDEA and STS Camp from any and all liability related to medical treatment. In addition, I assume the risk and financial responsibility for any injury resulting from the attendee's participation in all STS Camp events.

Media Consent. By signing this document, I also acknowledge that my child's photographs may be used in any responsible fashion, by SDEA or STS Camp, in its sole discretion, including but not limited to publications, videos, and websites.

Please check, which applies:

☐ Parent/Guardian ☐ Attendee 18 years of age or older Signature: _____

If you are a Parent/Guardian of an attendee who is under 18 years of age, please include the following:

Your Name: _____ Relationship to Attendee: _____

Phone Number: _____



CAMP RULES OF CONDUCT

Dear Retreat Coordinator,

Please go over these rules of conduct with your group at orientation. Your help in these areas will allow us to preserve a safe and pleasant environment and be a Christian witness to the residents who live around the Laguna Campus. As the leader of your group, it is your responsibility to communicate these policies to your students.

CAMP CURFEWS

Groups must be off beach and within campus boundaries by 11pm CST. Groups shall be quiet and in their rooms by midnight. Pools, basketball, volleyball, and gaga ball courts close at 11:00 pm CST. Amplified music is not allowed after 10:00 pm CST.

NOISE VIOLATIONS

Groups are subject to local laws concerning noise dB levels. This includes your meeting room and any other area of the campus including the beach.

Amplified music and other activities that produce noise shall only take place between the hours of 8:00 am CST and 10:00 pm CST. LBCR reserves the right to monitor and adjust dB sound levels and bass to comply with local sound ordinances. Groups that violate this policy are subject to governmental fines.

PUBLIC ACCESS TO BEACH / PRIVATE PROPERTY

Please use the public access paths to go to the beach. All other land along the beach is privately owned. Please show respect for our neighbors by not trespassing on their property. Stay off the sea oats near the dunes.

BEACH FLAG WARNING SYSTEM

Panama City Beach has a flag warning system to ensure safe swimming in the Gulf of Mexico. Please note the flag color daily and adjust your groups swimming activities in the Gulf. **Text "PCBFLAGS" to 888777 to receive text updates on flag conditions.**

DOUBLE RED FLAGS	Water Closed to Public.
RED FLAG	High Hazard - High Surf and/or Strong Currents
YELLOW FLAG	Medium Hazard - Moderate Surf and/or Currents
GREEN FLAG	Low Hazard - Calm Conditions, Exercise Caution
PURPLE FLAG	Dangerous Marine Life – Shark, Jellyfish, Stingray, etc.

CAMP RULES OF CONDUCT CONTINUED

PROHIBITED ACTIVITIES

- Shaving Cream fights, water balloon fights, squirt guns
- Weapons, Drugs, Alcohol, Smoking, Vaping
- Fireworks
- Loud noise and amplified music before 8:00 am or after 10:00 pm CST
- Bikes, Scooters, and Skateboards
- Running/Hazardous play around swimming pools
- Littering

DAMAGES

Damages will be assessed for vandalism, horseplay, and carelessness. We charge \$75 per hole for sheet rock damage.

SUPERVISION

Groups shall provide at least one adult chaperone to reside in any room where minors are housed. Also, provide visual/safety supervision in meeting rooms and outdoor recreation areas. Lifeguards are not present at any pools or the Gulf of Mexico. It is the responsibility of the group leader(s) to provide safety and supervision of all swimming pools and the Gulf of Mexico. Please lock your housing rooms when you are at the beach or in meetings. Please instruct your group to use the pedestrian cross walks when going to the beach and to wait for traffic to come to a complete stop before crossing Front Beach Rd. Please be aware of vehicles on the side roads surrounding the Campus. Do not block the street with large groups of students.

MAINTENANCE

Please help us by informing everyone on your staff to report maintenance problems, questions about policies, and requests of any kind to the office, gift shops, or any of our staff on the grounds. Our friendly staff will then get word immediately to the right person to handle your need. **Our phone number is 850-234-2502.**

TRASH ON BEACH & GROUNDS

Help us keep the beach and our campus clean for everyone by not littering. Trash receptacles are provided on the beach and throughout the campus.



WHAT PARENTS & COUNSELORS NEED TO KNOW

WHERE: We are located at 20016 Front Beach Road Panama City Beach FL 32413. We are on the west end of Panama City Beach miles away from the tourist-filled beaches, in a less congested area that is safe and conducive for camp.

HOUSING: We have apartment/motel style, beach cottages and dormitory style units, with bunk beds (double beds in some units), heated and air-conditioned throughout. All units have inside bathroom facilities with plenty of hot water. Coin laundry facilities are also available on campus.

MEALS: Food can be prepared in large, fully-equipped kitchens by staff from your church. We also offer a catering option for your meals. Nutrition guides and ingredient lists for all of our meals are available upon request. We also have our Laguna Grill and Laguna Beach Coffee & Cream restaurants open throughout the day.

WORSHIP: Air-conditioned meeting rooms come with tables, chairs, podium, TV, DVD player, projector screens & a dry erase board with markers. Groups provide their own sound systems.

RECREATION: The beautiful sand and surf of the Gulf of Mexico. Volleyball, basketball, and gaga ball courts are located throughout the campus and lighted for night play. We have 16 swimming pools with 4 heated pools available from Nov 1 to May 1. Our gift shops are open year-round as well.

CONTACT INFO: Our office number 850-234-2502, our physical address is 20016 Front Beach Rd. Panama City Beach FL 32413. Be sure to put the student name and group name on any packages or mail

EMERGENCIES CALL 911
Sacred Heart Bay

WHAT TO BRING: Bed linens (Queen, Full, Twin, or a sleeping bag), pillow, towels, toiletries and your Bible.

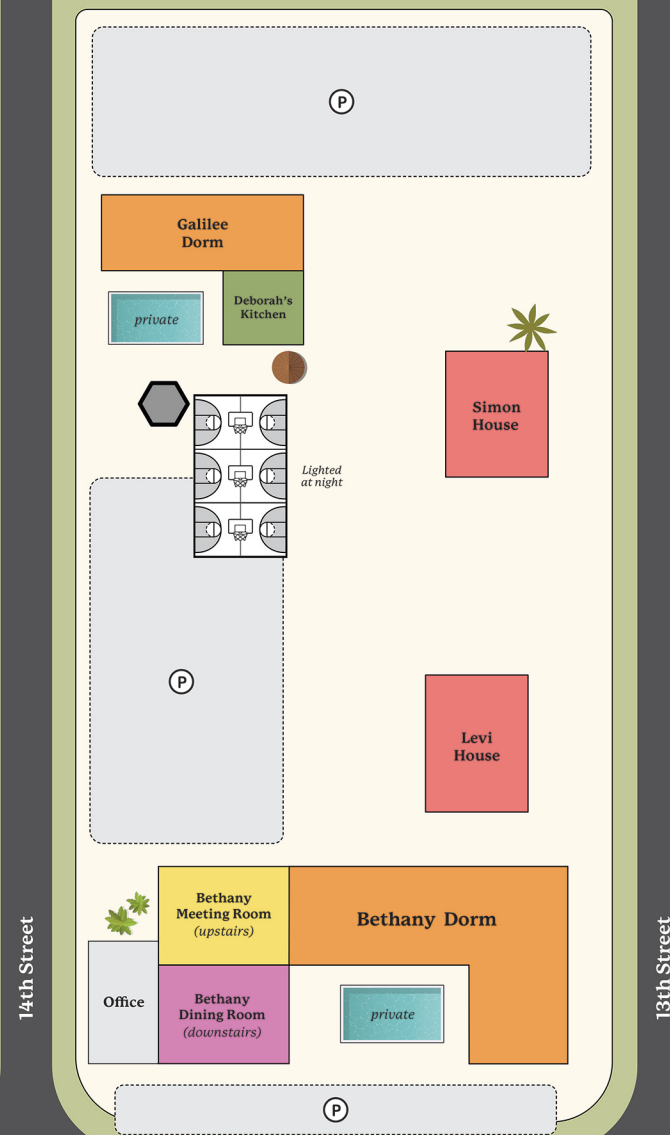
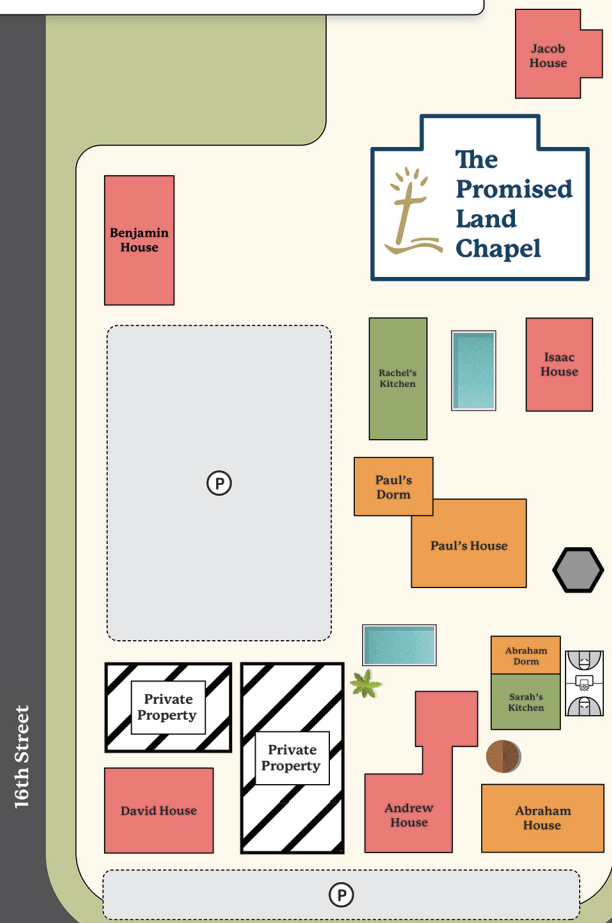

Front Beach Road Hwy 98-A

Front Beach Road Hwy 98-A

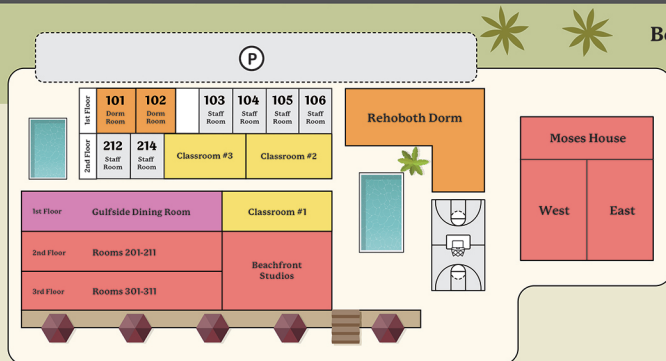

Beach Access #79

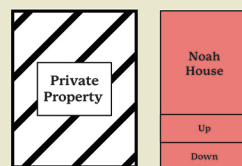

Beach Access #78

Legend

 GROUP ACCOMMODATIONS

 FAMILY ACCOMMODATIONS

 KITCHENS

 DINING ROOMS

 MEETING ROOMS

 PARKING

 LAUNDRY

 GAGA BALL

 GAZEBO

 GIFT SHOP / COFFEE SHOP / THE GRILL

Gulf of Mexico



COTTAGES

CHRISTIAN RETREAT

CAMP RULES OF CONDUCT

Dear Retreat Coordinator,

Please go over these rules of conduct with your group at orientation. Your help in these areas will allow us to preserve a safe and pleasant environment to the residents who live around the Cottages property. As the leader of your group, it is your responsibility to communicate these policies to your students.

CAMP CURFEWS

Groups must be off beach and within campus boundaries by 11pm CST. Groups shall be quiet and in their rooms by midnight. Pools, basketball, volleyball, and gaga ball courts close at 11:00 pm CST. Amplified music is not allowed after 10:00 pm CST.

NOISE VIOLATIONS

Groups are subject to local laws concerning noise dB levels. **Amplified music and other activities that produce noise shall only take place between the hours of 8:00 am CST and 10:00 pm CST.** CCR reserves the right to monitor and adjust dB sound levels and bass to comply with local sound ordinances. Groups that violate this policy are subject to governmental fines.

PUBLIC ACCESS TO BEACH / PRIVATE PROPERTY

Please use the public access paths to go to the beach. All other land along the beach is privately owned. Please show respect for our neighbors by not trespassing on their property. Stay off the sea oats near the dunes.

BEACH SAFETY

Please learn the beach warning flags and the safety guidelines on escaping rip currents and heed their instruction. The signs below are also posted in all rooms and dorms.

